



**LICENSING  
SUB-COMMITTEE**

**REPORT**

19 03 2012

**Subject Heading:**

Premises Licence Application  
Stumbras 26 Victoria Road RM1 2JH

**Report Author and contact details:**

Paul Campbell – Licensing Officer  
01708 432777  
[licensing@havering.gov.uk](mailto:licensing@havering.gov.uk)

This application for a premises licence is made by Laura Skackauskaite under section 17 of the Licensing Act 2003. The application was received by Havering's Licensing Authority on 27<sup>th</sup> January 2012.

**Geographical description of the area and description of the building**

The premises are a single unit terrace shop on the ground floor with residential flats above.

The premises are located on the south side of Victoria Road approximately 100 metres east of South Street Romford this is inside the Romford Ring Road and falls within Havering's saturation area for Romford. The area surrounding the property in Victoria Road are all shops or commercial premises on the ground floor with residential properties above. Within 200 metres of the shop there are 9 premises which offer alcohol for off sales, 9 pubs or bars and a large number of restaurants that offer alcohol with meals.

The premises are located very close to Romford rail station and other public transport links.

A map of the area is attached to assist the committee.

**Details of the application**

<b>Supply of Alcohol (off Supplies Only)</b>		
<b>Day</b>	<b>Start</b>	<b>Finish</b>
Monday to Sunday	10:00hrs	23:00hrs

**Licensing Sub-Committee, 19 March 2012**

**Seasonal variations & Non-standard timings**

There are no seasonal variations or non-standard timings |Applied for in this application.

**Comments and observations on the application**

The applicant acted in accordance with premises licence regulations 25 and 26 relating to the advertising of the application. The required newspaper advertisement was installed in the Romford Recorder on Friday 3<sup>rd</sup> February 2012.

**Summary**

There were no valid representations against this application from interested parties.

There was one representation against this application from responsible authorities.

**Details of representations**

Valid representations may only address the following licensing objectives:

The prevention of crime and disorder  
The prevention of public nuisance  
The protection of children from harm  
Public safety

**Responsible Authorities' representations**

The Metropolitan Police representation outlines their concerns about the granting of this licence mainly on the grounds of crime and disorder

There were no representations from the following responsible authorities:

Public Health  
The London Fire and Emergency Planning Authority  
The Health & Safety Enforcing Authority  
The Trading Standards Service  
Planning Control & Enforcement  
Children & Families Service

## **Licensing Sub-Committee**

**Appendix 1** - Copy of the Application

\* required information

### Section 1 of 22

You can save the form at any time and resume it later. You do not need to be logged in when you resume.

System reference  This is the unique reference for this application generated by the system.

Your reference  You can put what you want here to help you track applications if you make lots of them. It is passed to the authority.

Are you an agent acting on behalf of the applicant?

Yes  No

Put "no" if you are applying on your own behalf or on behalf of a business you own or work for.

### Applicant Details

\* First name

\* Family name

\* E-mail

Main telephone number

Include country code.

Other telephone number

Indicate here if the applicant would prefer not to be contacted by telephone

Is the applicant:

Applying as a business or organisation, including as a sole trader  
 Applying as an individual

A sole trader is a business owned by one person without any special legal structure. Applying as an individual means the applicant is applying so the applicant can be employed, or for some other personal reason, such as following a hobby.

### Applicant Business

\* Is the applicant's business registered in the UK with Companies House?  Yes  No

\* Is the applicant's business registered outside the UK?  Yes  No

\* Business name

If the applicant's business is registered, use its registered name.

\* VAT number

Put "none" if the applicant is not registered for VAT.

Continued from previous page...

\* Legal status

\* Applicant's position in the business

Home country

The country where the applicant's headquarters are.

**Applicant Business Address**

If the applicant has one, this should be the applicant's official address - that is an address required of the applicant by law for receiving communications.

\* Building number or name

\* Street

District

\* City or town

County or administrative area

\* Postcode

\* Country

**Agent Details**

\* First name

\* Family name

\* E-mail

Main telephone number

Include country code.

Other telephone number

Indicate here if you would prefer not to be contacted by telephone

Are you:

An agent that is a business or organisation, including a sole trader

A sole trader is a business owned by one person without any special legal structure.

A private individual acting as an agent

**Agent Business**

\* Is your business registered in the UK with Companies House?  Yes  No

\* Registration number

\* Business name

If your business is registered, use its registered name.

\* VAT number

Put "none" if you are not registered for VAT.

\* Legal status

**Continued from previous page...**

\* Your position in the business

Home country

The country where the headquarters of your business is located.

**Agent Registered Address**

Address registered with Companies House.

\* Building number or name

\* Street

District

\* City or town

County or administrative area

\* Postcode

\* Country

The information given here will be saved and will be pre-filled in future forms.

**Section 2 of 22**

**PREMISES DETAILS**

I/we, as named in section 1, apply for a premises licence under section 17 of the Licensing Act 2003 for the premises described in section 2 below (the premises) and I/we are making this application to you as the relevant licensing authority in accordance with section 12 of the Licensing Act 2003.

**Premises Address**

Are you able to provide a postal address, OS map reference or description of the premises?

Address     OS map reference     Description

**Postal Address Of Premises**

Building number or name

Street

District

City or town

County or administrative area

Postcode

Country

**Further Details**

Telephone number

**Continued from previous page...** Non-domestic rateable  
value of premises (£)

7,600

**Section 3 of 22**

**APPLICATION DETAILS**

In what capacity are you applying for the premises licence?

- An individual or individuals
- A limited company
- A partnership
- An unincorporated association
- A recognised club
- A charity
- The proprietor of an educational establishment
- A health service body
- A person who is registered under part 2 of the Care Standards Act 2000 (c14) in respect of an independent hospital in Wales
- A person who is registered under Chapter 2 of Part 1 of the Health and Social Care Act 2008 in respect of the carrying on of a regulated activity (within the meaning of that Part) in an independent hospital in England
- The chief officer of police of a police force in England and Wales
- Other (for example a statutory corporation)

**Confirm The Following**

- I am carrying on or proposing to carry on a business which involves the use of the premises for licensable activities
- I am making the application pursuant to a statutory function
- I am making the application pursuant to a function discharged by virtue of Her Majesty's prerogative

**Section 4 of 22**

**INDIVIDUAL APPLICANT DETAILS**

Continued from previous page...

**Applicant Name**

Is the name the same as (or similar to) the details given in section one?

Yes  No

If "Yes" is selected you can re-use the details from section one, or amend them as required. Select "No" to enter a completely new set of details.

First name

Family name

Is the applicant 18 years of age or older?

Yes  No

**Applicant Postal Address**

Is the address the same as (or similar to) the address given in section one?

Yes  No

If "Yes" is selected you can re-use the details from section one, or amend them as required. Select "No" to enter a completely new set of details.

Building number or name

Street

District

City or town

County or administrative area

Postcode

Country

**Applicant Contact Details**

Are the contact details the same as (or similar to) those given in section one?

Yes  No

If "Yes" is selected you can re-use the details from section one, or amend them as required. Select "No" to enter a completely new set of details.

E-mail

Telephone number

Other telephone number

**Section 5 of 22**

**OPERATING SCHEDULE**

When do you want the premises licence to start?  /  /   
dd mm yyyy

If you wish the licence to be valid only for a limited period, when do you want it to end  /  /   
dd mm yyyy



**Continued from previous page...**

If 5,000 or more people are expected to attend the premises at any one time, state the number expected to attend

Provide a general description of the premises

For example the type of premises, its general situation and layout and any other information which could be relevant to the licensing objectives. Where your application includes off-supplies of alcohol and you intend to provide a place for consumption of these off- supplies you must include a description of where the place will be and its proximity to the premises.

The premises is an off license set amongst a row of single and double storey business's including take aways and other local services, with off road parking to the front of the premises. Located in a residential area of Romford.

**Section 6 of 22**

**PROVISION OF PLAYS**

Will you be providing plays?

Yes

No

**Section 7 of 22**

**PROVISION OF FILMS**

Will you be providing films?

Yes

No

**Section 8 of 22**

**PROVISION OF INDOOR SPORTING EVENTS**

Will you be providing indoor sporting events?

Yes

No

**Section 9 of 22**

**PROVISION OF BOXING OR WRESTLING ENTERTAINMENTS**

Will you be providing boxing or wrestling entertainments?

Yes

No

**Section 10 of 22**

**PROVISION OF LIVE MUSIC**

Will you be providing live music?

Yes

No

**Section 11 of 22**

**PROVISION OF RECORDED MUSIC**

Will you be providing recorded music?

Yes

No

**Section 12 of 22**

Continued from previous page...

**PROVISION OF PERFORMANCES OF DANCE**

Will you be providing performances of dance?

Yes  No

**Section 13 of 22**

**PROVISION OF ANYTHING OF A SIMILAR DESCRIPTION TO LIVE MUSIC, RECORDED MUSIC OR PERFORMANCES OF DANCE**

Will you be providing anything similar to live music, recorded music or performances of dance?

Yes  No

**Section 14 of 22**

**PROVISION OF FACILITIES FOR MAKING MUSIC**

Will you be providing facilities for making music?

Yes  No

**Section 15 of 22**

**PROVISION OF FACILITIES FOR DANCING**

Will you be providing facilities for dancing?

Yes  No

**Section 16 of 22**

**PROVISION OF FACILITIES FOR ENTERTAINMENT OF A SIMILAR DESCRIPTION TO THOSE PROVIDED FOR MAKING MUSIC OR DANCING**

Will you be providing facilities similar in nature to those provided for making music or dancing?

Yes  No

**Section 17 of 22**

**LATE NIGHT REFRESHMENT**

Will you be providing late night refreshment?

Yes  No

**Section 18 of 22**

**SUPPLY OF ALCOHOL**

Will you be selling or supplying alcohol?

Yes  No

**Standard Days And Timings**

MONDAY

Start

End

Start

End

TUESDAY

Start

End

Start

End

Give timings in 24 hour clock.  
(e.g., 16:00) and only give details for the days  
of the week when you intend the premises  
to be used for the activity.

Continued from previous page...

WEDNESDAY

Start 10:00

End 23:00

Start

End

THURSDAY

Start 10:00

End 23:00

Start

End

FRIDAY

Start 10:00

End 23:00

Start

End

SATURDAY

Start 10:00

End 23:00

Start

End

SUNDAY

Start 10:00

End 23:00

Start

End

Will the sale of alcohol be for consumption:

- On the premises     Off the premises     Both

If the sale of alcohol is for consumption on the premises select on, if the sale of alcohol is for consumption away from the premises select off. If the sale of alcohol is for consumption on the premises and away from the premises select both.

State any seasonal variations

For example (but not exclusively) where the activity will occur on additional days during the summer months.

Non-standard timings. Where the premises will be used for the supply of alcohol at different times from those listed in the column on the left, list below

For example (but not exclusively), where you wish the activity to go on longer on a particular day e.g. Christmas Eve.

State the name and details of the individual whom you wish to specify on the licence as premises supervisor

**Continued from previous page...**

**Name**

First name

Family name

**Enter the contact's address**

Building number or name

Street

District

City or town

County or administrative area

Postcode

Country

Personal Licence number (if known)

Issuing licensing authority (if known)

**PROPOSED DESIGNATED PREMISES SUPERVISOR CONSENT**

How will the consent form of the proposed designated premises supervisor be supplied to the authority?

- Electronically, by the proposed designated premises supervisor
- As an attachment to this application

Reference number for consent form (if known)

If the consent form is already submitted, ask the proposed designated premises supervisor for its 'system reference' or 'your reference'.

**Section 19 of 22**

**ADULT ENTERTAINMENT**

Highlight any adult entertainment or services, activities, or other entertainment or matters ancillary to the use of the premises that may give rise to concern in respect of children

Give information about anything intended to occur at the premises or ancillary to the use of the premises which may give rise to concern in respect of children, regardless of whether you intend children to have access to the premises, for example (but not exclusively) nudity or semi-nudity, films for restricted age groups etc gambling machines etc.

none

**Section 20 of 22**

**HOURS PREMISES ARE OPEN TO THE PUBLIC**

Continued from previous page...

**Standard Days And Timings**

MONDAY

Start

End

Start

End

Give timings in 24 hour clock.  
(e.g., 16:00) and only give details for the days  
of the week when you intend the premises  
to be used for the activity.

TUESDAY

Start

End

Start

End

WEDNESDAY

Start

End

Start

End

THURSDAY

Start

End

Start

End

FRIDAY

Start

End

Start

End

SATURDAY

Start

End

Start

End

SUNDAY

Start

End

Start

End

State any seasonal variations

For example (but not exclusively) where the activity will occur on additional days during the summer months.

Non standard timings. Where you intend to use the premises to be open to the members and guests at different times from those listed in the column on the left, list below

For example (but not exclusively), where you wish the activity to go on longer on a particular day e.g. Christmas Eve.

Continued from previous page...

**Section 21 of 22**

**LICENSING OBJECTIVES**

Describe the steps you intend to take to promote the four licensing objectives:

a) General – all four licensing objectives (b,c,d,e)

List here steps you will take to promote all four licensing objectives together.

The premises are to be used for off sales only. There is a CCTV system with recording in place on site. Appropriate staff training will be given to any staff member selling alcohol, Training records will be made available upon request. Appropriate training manual, refusals book and challenge 21 will be initiated.

b) The prevention of crime and disorder

Alcohol will only be served for consumption off the premises.  
The alcohol will not be stored in a position that would lead to theft.  
Staff training to challenge all customers who appear to be under the age of 21 with a no Proof, no Purchase rule.

The CCTV system consists of four cameras and monitor and will provide for 30 days recordable playback and will be available for immediate playback by trained staff upon request.

c) Public safety

The premises will be carefully managed by the Designated Premises Supervisor and CCTV footage will be available on hard drive for a minimum of 30 days, if so requested.

d) The prevention of public nuisance

The supply of alcohol will be restricted to off sales only. The customers purchasing alcohol will not be allowed to congregate around the area, but must leave the premises immediately after the transaction has taken place.

e) The protection of children from harm

Alcohol will not be served to children .  
Anyone who looks under the age of 21 will be asked to produce proof of age.

**Section 22 of 22**

**PAYMENT DETAILS**

This fee must be paid to the authority. If you complete the application online, you must pay it by debit or credit card. Premises Licence Fees are determined by the non domestic rateable value of the premises.

To find out a premises non domestice rateable value go to the Valuation Office Agency site at [http://www.voa.gov.uk/business\\_rates/index.htm](http://www.voa.gov.uk/business_rates/index.htm)

Band A - No RV to £4300 - £100

Band B - £4301 to £33000 - £190.00

**Continued from previous page...**

Band C - £33001 to £87000 - £315.00

Band D - £87001 to £125000 - £450.00\*

Band E - £125001 and over - £635.00\*

\*If the premises rateable value is in Bands D or E and the premises is primarily used for the consumption of alcohol on the premises then you are required to pay a higher fee.

Band D - £87001 to £125000 - £900.00

Band E - £125001 and over - £1,905.00

There is an exemption from the payment of fees in relation to the provision of regulated entertainment at church halls, chapel halls, or premises of a similar nature, village halls, parish or community halls, or other premises of a similar nature. The costs associated with these licences will be met by Central Government. If, however, the licence also authorises the use of the premises for the supply of alcohol or the provision of late night refreshment, a fee will be required.

Schools and sixth form colleges are exempt from the fees associated with the authorisation of regulated entertainment where the entertainment is provided by and at the school or college and for the purposes of the school or college.

If you operate a large event you are subject to ADDITIONAL fees based upon the number of attendance at any one time.

Capacity 5000 to 9999 - £1,000.00

Capacity 10000 to 14999 - £2,000.00

Capacity 15000 to 19999 - £4,000.00

Capacity 20000 to 29999 - £8,000.00

Capacity 30000 to 39999 - £16,000.00

Capacity 40000 to 49999 - £24,000.00

Capacity 50000 to 59999 - £32,000.00

Capacity 60000 to 69999 - £40,000.00

Capacity 70000 to 79999 - £48,000.00

Capacity 80000 to 89999 - £56,000.00

Capacity 90000 and over £64,000.00

\* Fee amount (£)

190.00

**ATTACHMENTS**

- Premises Plan
- Consent form of premises supervisor

**AUTHORITY POSTAL ADDRESS**

**Continued from previous page...**

**Address**

Building number or name	<input type="text" value="Mercury House"/>
Street	<input type="text" value="Mercury Gardens"/>
District	<input type="text" value="Romford"/>
City or town	<input type="text" value="Essex"/>
County or administrative area	<input type="text"/>
Postcode	<input type="text" value="RM1 3SL"/>
Country	<input type="text" value="uk"/>

**DECLARATION**

\* I/we understand it is an offence, liable on conviction to a fine up to level 5 on the standard scale, under Section 158 of the Licensing Act 2003, to make a false statement in or in connection with this application.

Ticking this box indicates you have read and understood the above declaration

This section should be completed by the applicant, unless you answered "Yes" to the question "Are you an agent acting on behalf of the applicant?"

* Full name	<input type="text"/>
* Capacity	<input type="text"/>
Date (dd/mm/yyyy)	<input type="text"/>



# CCTV System.

## Surveillance Tubs

### SV-244S

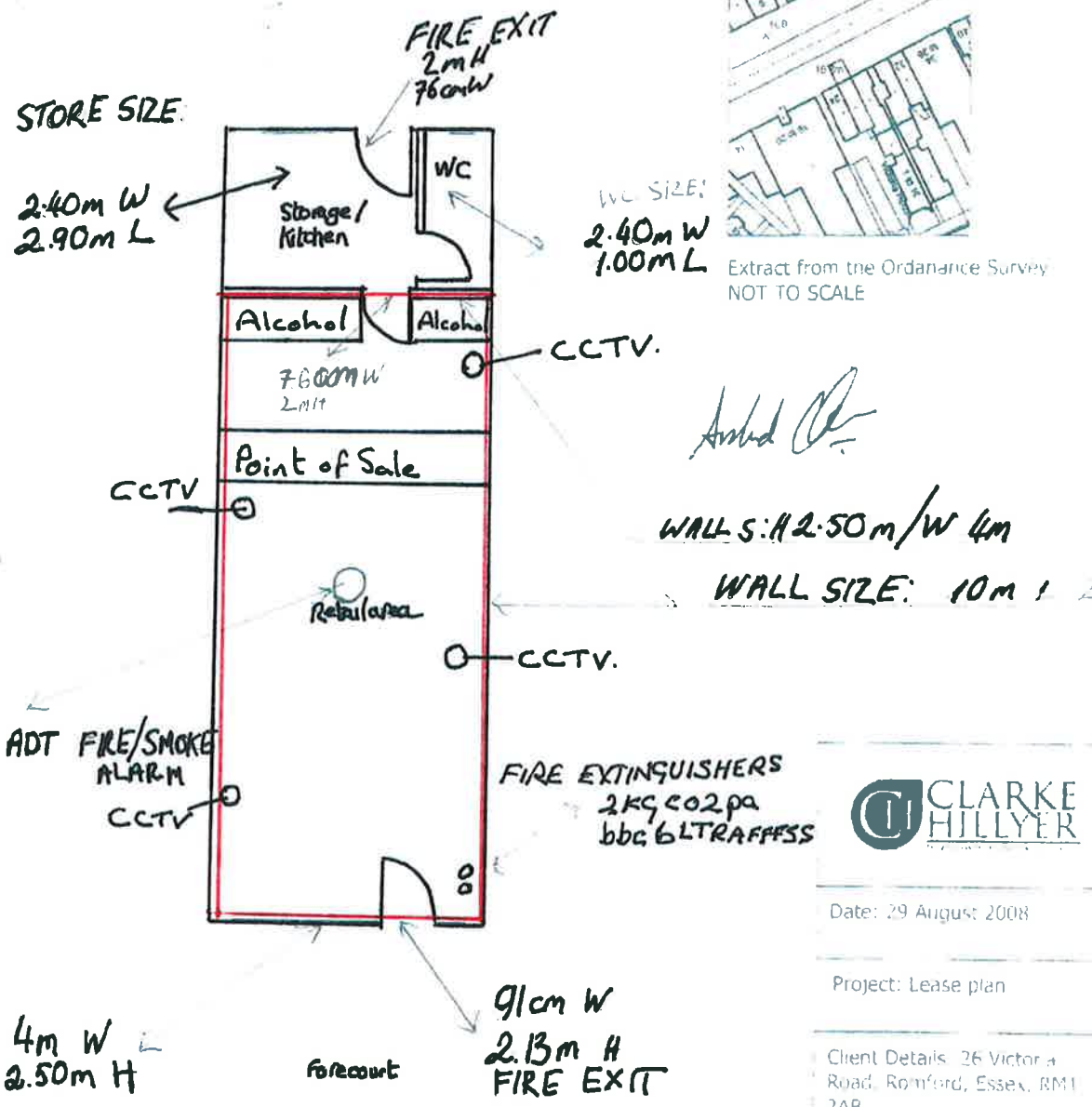

**SHELVES SIZE:** H: 2.22m  
W: 1.20m

**CLARKE HILLYER**

Date: 29 August 2008

Project: Lease plan

Client Details: 26 Victoria Road, Romford, Essex, RM1 2AB

Drawing Number: 26VF

Drawing Scale: 1:100

**ADVERTISING ENQUIRIES**

**CALL 0845 671 4460**

**NOTICE OF APPLICATION FOR A PREMISES LICENCE UNDER SECTION 17 OF THE LICENSING ACT 2003**

**Applicant:** Costcutter Hornchurch **Location of Premises:** 18a Station Lane, Hornchurch, Essex, RM12 6NJ has applied to the London Borough of Havering for the proposed licensable activity is: The sale of alcohol for consumption off premises from 7am to 11pm Monday to Sunday. Such representation must be received in writing by 26th February 2012, clearly stating the grounds upon which the representation is made in relation to the four objectives of the Licensing Act 2003. Full details of the application can be inspected at the address noted below during normal business hours. Any representations by an interested party or responsible authority regarding this application can be made to: London Borough of Havering, Licensing Team Mercury House, Mercury Gardens Romford, RM1 3RX. Website: www.havering.gov.uk. It is an offence to knowingly or recklessly make a false statement in connection with an application. The maximum fine for which a person is liable on summary conviction for the offence is £5,000.00.

**Licensing Act 2003**

**Notice of application for a new premises licence**

Laura Skackauskaite is applying for the new grant of a Premises Licence for Stumbras, 26 Victoria Road, Romford, Essex, RM1 2JH. If granted the application will be for the sale of alcohol Monday to Sunday, from 1000 hours to 2300 hours. Any person wishing to make representations in relation to this application must do so in writing, including their name, address & telephone number by no later than the 24 February, 2012 to London Borough of Havering, Licensing Team, 5th Floor Mercury House, Mercury Gardens, Romford, Essex, RM1 3SL. It is an offence knowingly or recklessly to make a false statement in connection with an application, a person doing so may be liable to a fine on conviction or up to £5,000.

AQI  
4'  
pi  
or

AQI  
1'  
hi

TIBI  
PL  
DC  
Int  
£5

ROF  
OW  
G

Th  
ma  
are  
chilc  
th

**SUDESH MADAN deceased**

Pursuant to Section 27, Trustee Act 1925 (as amended)

Notice is hereby given that any person having a claim against or an interest in the Estate of the above named, late of 12 Homeway, Romford, Essex, RM3 0HD, who died on 8 February 2011, and whose Will was proved on 12 January 2012, is required to send written particulars to the undersigned by 11 April 2012. After this date the Executor will distribute the Estate among the persons entitled thereto having regard only to the claims and interests of which he receives notice.

**Godloves, 8-16 Dock Street, Bridge End, Leeds LS10 1LX, Ref: HLD-66383-1**

*Solicitors for the Executor*

**ARTICLES FOR SALE**

**LENOX DISNEY** Crystal Winnie the Pooh (Hunny Tales) - £30 and (A Present for Pooh) - £30 and Tigger figurine - £15. 07972 829459

**VIOT SCHWENIG** Limited Edition, Wishing Well Cottage, £10, Geranium Gardens £10, Cobblestone Bridge £10, all 3 for £25. 07972 829459

**SHOWER PUMP**

Negative head, High Pressure, Stuart Turner - Monsoon Universal 2.5 Bar Twin Shower Pump 2 yrs old last July Reason for Sale - Changed System

**BABY AND NURSERY**

**PINE ROCKING** crib lovely rocking crib nearly new plus mattress n all pink handmade covers and canopy daughter dont like it paid £180 can deliver local £80 ono 07028410350 stacielyt-tle@gmail.com

**PINK PRINCESS DUVET** (SINGLE) WITH CUDDLE CUSHION FEATURING DISNEY PRINCESSES: BELLE, CINDERELLA, SNOW WHITE AND SLEEPING BEAUTY IN EXCELLENT CONDITION £10.00 BUYERMUST-COLLECT 07028410613 PLEASE CONTACT FOR MORE DETAILS

**BABYLAND**  
NEW & QUALITY  
HIGLAND BABY GOODS

**GOODS VEHICLE OPERATOR'S LICENCE**

L. T. MOTORS LTD of Unit 9F Salamons

## **Licensing Sub-Committee**

**Appendix 2** - Map of local area



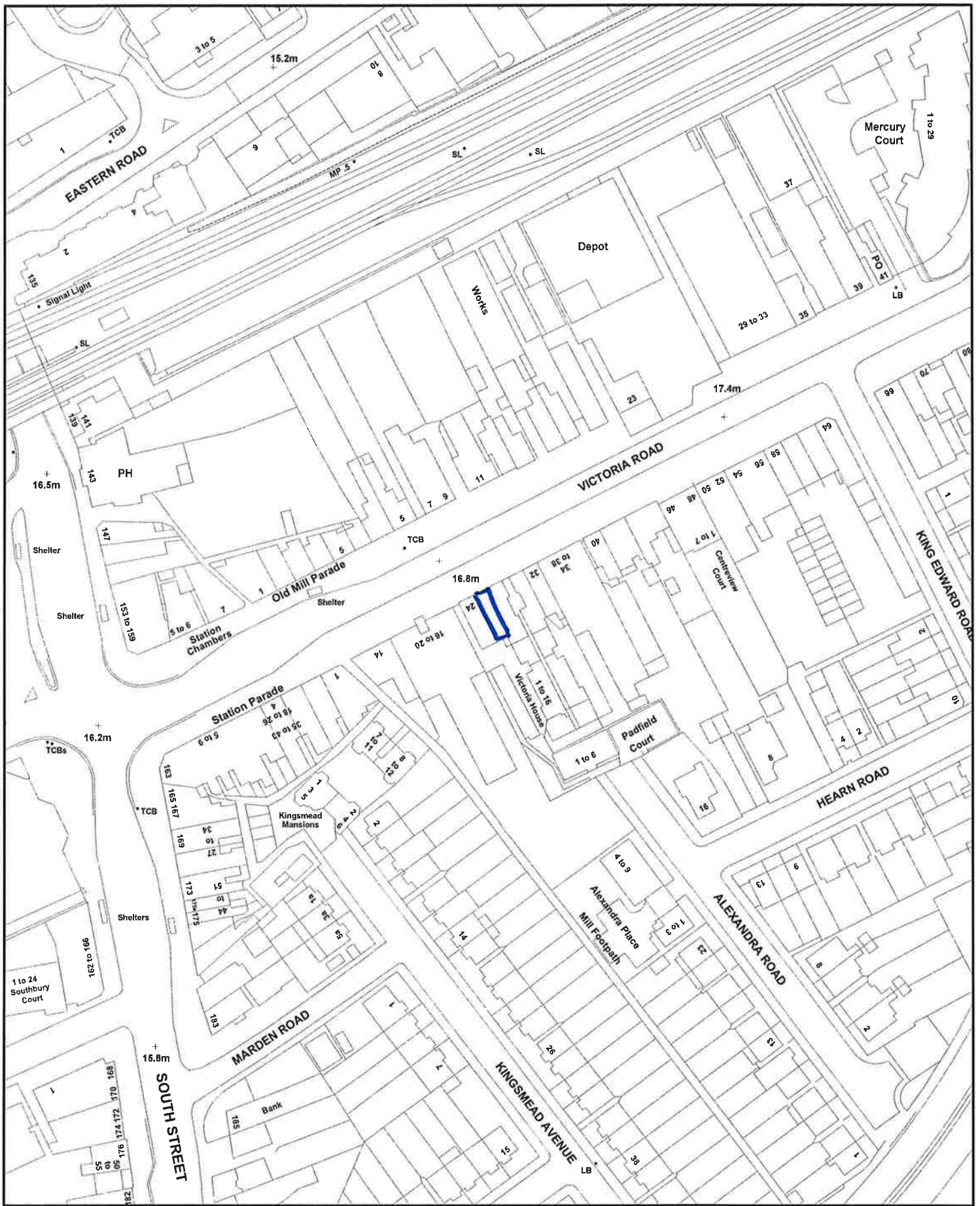

**Stumbras**

Map Reference: TQ5188SE



**nlp**  
National Land & Property Gazetteer

**NSG**  
NATIONAL STREET GAZETTEER

**Ordnance Survey**  
Licensed Partner

Scale @ A4 1:1250  
Date: 27/01/2012



**Havering**  
LONDON BOROUGH

London Borough of Havering  
Town Hall, Main Road  
Romford, RM1 3BD  
Tel: 01708 434343

© Crown copyright and database rights 2012 Ordnance Survey 100024327

## **Licensing Sub-Committee**

**Appendix 3** - Representations

 <b>METROPOLITAN POLICE</b> Working together for a safer London	
	<b>PC 118 KD David Fern</b>
<b>Licensing Authority</b> <b>London Borough Havering</b> <b>Mercury House, Mercury Gardens</b> <b>Romford</b> <b>RM1 3SL</b>	<b>Romford Police Station</b> 19 Main Road Romford, Essex RM1 3BJ  <b>Telephone:</b> 01708 432781 <b>Email:</b> <b>David-anthony.fern@met.police.uk</b> <b>Date: 6th February 2012</b>

**Stumbras 26 Victoria Road, Romford RM1**

Police wish to make representation **against** the application for a new premises license at the address above.

The premises falls within the saturation area and the application is far from exceptional. Beers and spirits from Eastern Europe can be bought in many shops and supermarkets are equally keen to anticipate consumer needs.

There are adequate off licences in the area, below are few located near or within 200 metre's on Stumbras.

- Key News and Food - SOUTH STREET
- Am and Pm - SOUTH STREET
- Sainsburys - THE BREWERY
- Londis - SOUTH STREET
- Lidil - ATLANTA BOULEVARD
- Maxium Food stores - VICTORIA STREET
- Afforda - SOUTH STREET
- J and B connivance store - SOUTH STREET
- Asda - LIBERTY MALL

The borough of Havering is amongst the highest within the Metropolitan Police for alcohol fuelled violence.

I have enclosed the most recent data on ABH and GBH assaults on the last page of this representation. This gives you an indication of the factors police are presented with in the town centre. It also illustrates the time and days of these offences.

- Off licences play a key role in fuelling the availability of alcohol and often are cheaper then pubs and bars. There is a term in policing referred to as pre loading. This is where a person consumes alcohol prior to attending licensed premises, so the full effects of the alcohol consumed as probably not been felt by that person yet.

- The town centre experiences several issues on pre loading, off licences that sell within the ring road do so with the condition that the alcohol is not consumed in the streets within the ring road.
- This is often disregarded by the person who purchases the item and is consumed within a proximately of the off licence. Many subjects then remain in the town centre afterwards.
- Off licences do not inform customers of this as it would probably result in loosing a sale.

Police are tasked to deal with such issues; they have powers to remove the alcohol and open and sealed containers, if they believe that they will consume or being consumed within the designated area.

The saturation zone within the town centre is the designated area. Police spend a lot of there time dealing with such matters in an attempt to prevent further crime and disorder and public nuisance.

There have been approximately 120 people who have had alcohol confiscated from tasking results alone for the town centre within 12 months.

**This is not the final figure this represents when officers in the designated zone have supplied a tasking return to the intelligence unit.**

- Alcohol confiscation which is a direct result of off licence sales. Many premises are often totally unaware of the affects they create. These issues are a constant task for police officers.
- Police also issues section 27 notices under the violent crime and reduction act, which requires a person to leave a locality if the officer feels their presence will cause or contribute to alcohol related crime. 341 such notices have been given in the last 12 months.
- These figures I present to you I hope give you a clear picture of what police area tasked to deal with in the area.

Stumbras Store falls within the saturation zone and within the designated area for alcohol confiscation.

The cumulative impact on this area by allowing another premises to open will add to the levels of disorder already in the saturation zone, an aggregated effect.

There is evidence to suggest that customer from off licences contribute to the global difficulties within the town centre.

This area suffers from a series of difficulties that have arisen from a concentration of licensed premises in the town centre. The cumulative effect is violence on and off premises, noise and nuisance, large gatherings of people, littering and fouling and a deteriorating public realm.

There is not a single operator who is to blame but together they all impact on the town centre, the current situation of the impact does not promote the licensing objectives.

I ask the committee **not to grant** this application. The police believe this will generate further crime and disorder along with public nuisance through cumulative impact. This application will therefore not promote the licensing objectives, prevention of crime and disorder, public nuisance and lead to public safety.

If I can be of any further assistance in this matter please do not hesitate to contact me in the licensing office.

Yours sincerely

PC David Fern  
Metropolitan police - Havering  
Licensing officer



FIVE YEAR DATA Current 01/01/2012

Temporal analysis of GBH offences shows that the peak time for offences is between the hours of 2200-0400 with 79.5% of offences within this time period.

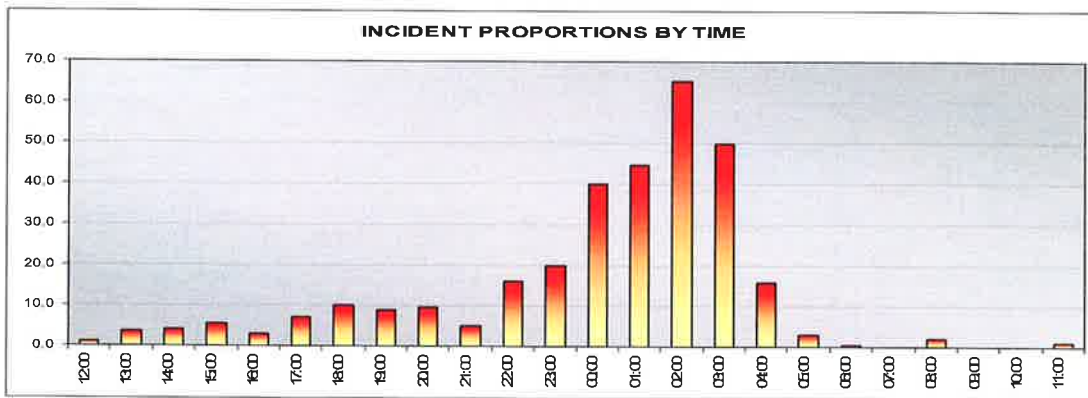
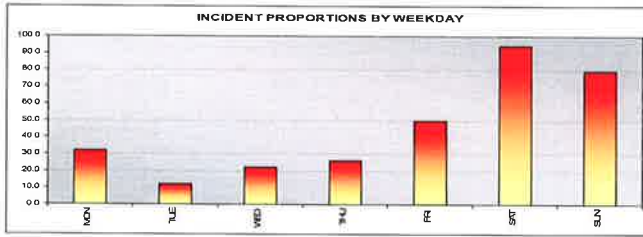

Temporal analysis of ABH shows that the peak time for offences is overnight 2200-0400 with 59.4% of offences during his time period.

